

Public Document Pack

Blackpool Council

4 March 2024

To: Councillors Baker, S Brookes and Roe and D Scott (Reserve)

The above members are requested to attend the:

LICENSING PANEL

Friday, 15 March 2024 at 10.00 am
in Committee Room B, Town Hall, Blackpool

A G E N D A

1 APPOINTMENT OF CHAIRMAN

To appoint a Chairman for the meeting.

2 DECLARATION OF INTEREST - LICENSING

Members are asked to declare any interests in the items under consideration and in doing so state:-

(1) the type of interest concerned

(2) the nature of the interest concerned; and

(3) whether they have or have not sat on a Planning Committee which has previously considered a planning application in respect of a licensed premises which is also subject to consideration for a premises licence as part of the agenda for this meeting.

If any Member requires advice on declarations of interests, they are advised to contact the Head of Democratic Governance in advance of the meeting.

3 PROCEDURE FOR THE MEETING

The Chairman of the Panel will summarise the procedure and announce the equal maximum amount of time for each party to speak for the hearing.

A. Items 1 and 4 (b) will be undertaken in private session by the Panel and not in the Meeting Room.

- B. Items 2, 3 and 4(a) will be recommended to the Panel to be held in public.
- C. The Panel may decide to exclude the public from all or part of a hearing where it considers that the public interest in so doing outweighs the public interest in the hearing, or that part of the hearing, taking place in public. (This includes a party and any person assisting or representing a party)

4 APPLICATION FOR A NEW PREMISES LICENCE - BARRONS HOTEL, 58-60 HORNBY ROAD (Pages 1 - 38)

To consider an application for a new Premises Licence for Barrons Hotel, 58-60 Hornby Road, Blackpool, FY1 4QJ.

- A. Application and representations submitted. To consider the attached report.
- B. Determination of the application to vary a Premises Licence – Barrons Hotel.

The Licensing Panel will indicate how the decision is to be communicated to interested parties.

Venue information:

First floor meeting room (lift available), accessible toilets (ground floor), no-smoking building.

Other information:

For queries regarding this agenda please contact Sarah Chadwick, Democratic Governance Senior Advisor, Tel: 01253 477153, e-mail sarah.chadwick@blackpool.gov.uk

Copies of agendas and minutes of Council and committee meetings are available on the Council's website at www.blackpool.gov.uk.

Report to:	LICENSING PANEL
Relevant Officer:	Lisa Ribchester, Licensing Officer
Date of Meeting:	15 March 2024

APPLICATION FOR A PREMISES LICENCE – Barrons Hotel, 58 – 60 Hornby Road, Blackpool, FY1 4QJ

1.0 Purpose of the report:

1.1 To consider an application for a New Premises Licence for Barrons Hotel, 58 – 60 Hornby Road, Blackpool, FY1 4QJ.

2.0 Recommendation(s):

2.1 The Panel is requested to consider the application and determine whether the granting of this licence would adversely impact on the Licensing Objectives.

3.0 Reasons for recommendation(s):

3.1 Representations have been received therefore there must be a hearing to determine the application.

3.2 Is the recommendation contrary to a plan or strategy adopted or approved by the Council? No

3.3 Is the recommendation in accordance with the Council's approved budget? Yes

4.0 Other alternative options to be considered:

4.1 None, once an application is submitted and representations received it must be considered by the Licensing Panel.

5.0 Council priority:

5.1 The relevant Council priority is:

- “The economy: Maximising growth and opportunity across Blackpool”

6.0 Background information

6.1 On 17th January 2024 the Licensing Service received an application from Mr Jose Sanchez on behalf of Cube Hotels Blackpool Ltd for a new Premises Licence at 58 – 60 Hornby Road, Blackpool, FY1 4QJ. The new application is a result of the previous licence lapsing due to the company that held that Premises Licence (Deneaspa Limited) showing as being dissolved on Companies House on 26 September 2023. This was discovered in January 2024 following a data cleanse on all licences by Licensing Officers. Deneaspa Limited (also owned by Mr Sanchez) held the previous licence since October 2022.

6.2 The application requests live music (Indoors and Outdoors) Friday to Sunday 12.00 – 23.00, recorded music (Indoors and Outdoors) Monday to Sunday 08.00 – 23.00, permission to sell alcohol (for consumption on and off the premises) Monday to Sunday 00.00 – 00.00, the provision of late night refreshment (Indoors) Monday to Sunday 23.00 – 05.00. The Premises would only be open to the public Monday to Sunday 11.00 – 23.00. The applicant has offered a number of conditions to be placed on the Premises Licence, plus additional conditions have been agreed with the Police by way of Mediation. A copy of the application is attached at Appendix 4a and the Police mediation at Appendix 4b.

6.3 A representation has been received from Councillor Mark Smith. A copy of the representation is attached at Appendix 4c.

6.4 Local policy considerations:

4.4.2 - The Council wishes to develop a diverse night-time economy but acknowledges that any licensable activity has the potential to impact adversely on the surrounding area either by disturbance caused by crime and disorder or by nuisance caused by customers being noisy when leaving/using on-street car parking. The impact of these activities can be greater at night when ambient noise levels are much lower.

6.5 National policy considerations:

9.12 - Each responsible authority will be an expert in their respective field, and in some cases it is likely that a particular responsible authority will be the licensing authority's main source of advice in relation to a particular licensing objective. For example, the police have a key role in managing the night-time economy and should have good working relationships with those operating in their local area⁵. The police should usually therefore be the licensing authority's main source of advice on matters relating to the promotion of the crime and disorder licensing objective. However, any responsible authority under the 2003 Act may make representations with regard to any of the licensing objectives if they have evidence to support such representations. Licensing authorities must therefore consider all relevant representations from responsible authorities carefully, even where the reason for a particular responsible authority's interest or expertise in the promotion of a particular objective may not be immediately apparent. However, it remains incumbent

on all responsible authorities to ensure that their representations can withstand the scrutiny to which they would be subject at a hearing.

9.43 – The authority’s decision should be evidence-based, justified as being appropriate for the promotion of the licensing objectives and proportionate to what it is intended to achieve.

6.6 Does the information submitted include any exempt information? No

7.0 List of Appendices:

7.1 Appendix 4a - Application form for a New Premises Licence
Appendix 4b – Police mediation agreement
Appendix 4c – Public objection (Councillor Mark Smith).

8.0 Financial considerations:

8.1 None.

9.0 Legal considerations:

9.1 Please see local and national policy in the background information.

10.0 Risk management considerations:

10.1 None.

11.0 Equalities considerations:

11.1 None.

12.0 Sustainability, climate change and environmental considerations:

12.1 None.

13.0 Internal/external consultation undertaken:

13.1 None.

14.0 Background papers:

14.1 None.

This page is intentionally left blank



Blackpool
Application for a premises licence
Licensing Act 2003

For help contact
licensing@blackpool.gov.uk
 Telephone: 01253 478397

* required information

Section 1 of 21

You can save the form at any time and resume it later. You do not need to be logged in when you resume.

System reference This is the unique reference for this application generated by the system.

Your reference You can put what you want here to help you track applications if you make lots of them. It is passed to the authority.

Are you an agent acting on behalf of the applicant?

Yes No

Put "no" if you are applying on your own behalf or on behalf of a business you own, or work for.

Applicant Details

* First name

* Family name

* E-mail

Main telephone number Include country code.

Other telephone number

Indicate here if you would prefer not to be contacted by telephone

Are you:

Applying as a business or organisation, including as a sole trader

Applying as an individual

A sole trader is a business owned by one person without any special legal structure. Applying as an individual means you are applying so you can be employed, or for some other personal reason, such as following a hobby.

Applicant Business

Is your business registered in the UK with Companies House? Yes No

Note: completing the Applicant Business section is optional in this form.

Registration number

Business name

If your business is registered, use its registered name.

VAT number none

Put "none" if you are not registered for VAT.

Legal status

Continued from previous page...

Your position in the business

Home country

The country where the headquarters of your business is located.

Registered Address

Address registered with Companies House.

Building number or name

Street

District

City or town

County or administrative area

Postcode

Country

Section 2 of 21

PREMISES DETAILS

I/we, as named in section 1, apply for a premises licence under section 17 of the Licensing Act 2003 for the premises described in section 2 below (the premises) and I/we are making this application to you as the relevant licensing authority in accordance with section 12 of the Licensing Act 2003.

Premises Address

Are you able to provide a postal address, OS map reference or description of the premises?

Address OS map reference Description

Postal Address Of Premises

Building number or name

Street

District

City or town

County or administrative area

Postcode

Country

Further Details

Telephone number

Non-domestic rateable value of premises (£)

Section 3 of 21**APPLICATION DETAILS**

In what capacity are you applying for the premises licence?

- An individual or individuals
- A limited company / limited liability partnership
- A partnership (other than limited liability)
- An unincorporated association
- Other (for example a statutory corporation)
- A recognised club
- A charity
- The proprietor of an educational establishment
- A health service body
- A person who is registered under part 2 of the Care Standards Act 2000 (c14) in respect of an independent hospital in Wales
- A person who is registered under Chapter 2 of Part 1 of the Health and Social Care Act 2008 in respect of the carrying on of a regulated activity (within the meaning of that Part) in an independent hospital in England
- The chief officer of police of a police force in England and Wales

Confirm The Following

- I am carrying on or proposing to carry on a business which involves the use of the premises for licensable activities
- I am making the application pursuant to a statutory function
- I am making the application pursuant to a function discharged by virtue of His Majesty's prerogative

Section 4 of 21**NON INDIVIDUAL APPLICANTS**

Provide name and registered address of applicant in full. Where appropriate give any registered number. In the case of a partnership or other joint venture (other than a body corporate), give the name and address of each party concerned.

Non Individual Applicant's Name

Name

Details

Registered number (where applicable)

Description of applicant (for example partnership, company, unincorporated association etc)

Continued from previous page...

COMPANY

Address

Building number or name

Street

District

City or town

County or administrative area

Postcode

Country

Contact Details

E-mail

Telephone number

Other telephone number

* Date of birth
dd mm yyyy

* Nationality Documents that demonstrate entitlement to work in the UK

Section 5 of 21

OPERATING SCHEDULE

When do you want the premises licence to start? / /
dd mm yyyy

If you wish the licence to be valid only for a limited period, when do you want it to end / /
dd mm yyyy

Provide a general description of the premises

For example the type of premises, its general situation and layout and any other information which could be relevant to the licensing objectives. Where your application includes off-supplies of alcohol and you intend to provide a place for consumption of these off- supplies you must include a description of where the place will be and its proximity to the premises.

HOTEL WITH BAR & RESTAURANT OPEN TO PUBLIC AND RESIDENTS (number 56 Hornby road fy1 4qj to have the same residents rights as 58/60 Horny Road Fy14qj i.e 24 hours as per previous licence PL0011
PROVISION OF LATE NIGHT REFRESHMENT
THE SUPPLY OF ALCOHOL
LATE NIGHT REFRESHMENT INDOORS LICENSED AREA MONDAY TO SUNDAY 23:00 TO 05:00 (NOT OPEN TO PUBLIC)

Continued from previous page...

SALE OF ALCOHOL FOR CONSUMPTION ON AND OFF THE PREMISES LICENSED AREA MONDAY TO SUNDAY 00:00 TO 00:00
(NOT OPEN TO PUBLIC)

If 5,000 or more people are expected to attend the premises at any one time, state the number expected to attend

Section 6 of 21

PROVISION OF PLAYS

See guidance on regulated entertainment

Will you be providing plays?

Yes

No

Section 7 of 21

PROVISION OF FILMS

See guidance on regulated entertainment

Will you be providing films?

Yes

No

Section 8 of 21

PROVISION OF INDOOR SPORTING EVENTS

See guidance on regulated entertainment

Will you be providing indoor sporting events?

Yes

No

Section 9 of 21

PROVISION OF BOXING OR WRESTLING ENTERTAINMENTS

See guidance on regulated entertainment

Will you be providing boxing or wrestling entertainments?

Yes

No

Section 10 of 21

PROVISION OF LIVE MUSIC

See guidance on regulated entertainment

Will you be providing live music?

Yes

No

Standard Days And Timings

MONDAY

Start

End

Start

End

Give timings in 24 hour clock. (e.g., 16:00) and only give details for the days of the week when you intend the premises to be used for the activity.

Continued from previous page...

TUESDAY

Start	<input type="text"/>	End	<input type="text"/>
Start	<input type="text"/>	End	<input type="text"/>

WEDNESDAY

Start	<input type="text"/>	End	<input type="text"/>
Start	<input type="text"/>	End	<input type="text"/>

THURSDAY

Start	<input type="text"/>	End	<input type="text"/>
Start	<input type="text"/>	End	<input type="text"/>

FRIDAY

Start	<input type="text" value="12:00"/>	End	<input type="text" value="23:00"/>
Start	<input type="text"/>	End	<input type="text"/>

SATURDAY

Start	<input type="text" value="12:00"/>	End	<input type="text" value="23:00"/>
Start	<input type="text"/>	End	<input type="text"/>

SUNDAY

Start	<input type="text" value="12:00"/>	End	<input type="text" value="23:00"/>
Start	<input type="text"/>	End	<input type="text"/>

Will the performance of live music take place indoors or outdoors or both?

Indoors Outdoors Both

Where taking place in a building or other structure tick as appropriate. Indoors may include a tent.

State type of activity to be authorised, if not already stated, and give relevant further details, for example (but not exclusively) whether or not music will be amplified or unamplified.

UNAMPLIFIED WITH TERRACES DOOR TO BE OPEN FROM 12NOON TILL 19.00PM DOORS TO BE CLOSED 19:00 WITH UNAMPLIFIED MUSIC.
AMPLIFIED MUSIC 12NOON TILL 23:00 INDOORS ONLY WITH DOORS CLOSED 12NOON TILL 23:00 WITH EXCEPTION OF TELEVISION THAT CAN BE HEARD AT A RESESONIBLE LEVEL TO BE ABLE TO HEAR THE PERSON NEXT TO YOU SPEAKING NORMALLY

State any seasonal variations for the performance of live music

For example (but not exclusively) where the activity will occur on additional days during the summer months.

Non-standard timings. Where the premises will be used for the performance of live music at different times from those listed in the column on the left, list below

Continued from previous page...

For example (but not exclusively), where you wish the activity to go on longer on a particular day e.g. Christmas Eve.

NEW YEARS EVE TO ALLOW AMPLIFIED MUSIC 19:00 FOR 6 HOURS TILL 01:00 THE FOLLOWING MORNING

Section 11 of 21

PROVISION OF RECORDED MUSIC

See guidance on regulated entertainment

Will you be providing recorded music?

Yes

No

Standard Days And Timings

MONDAY

Start

End

Start

End

Give timings in 24 hour clock.
(e.g., 16:00) and only give details for the days
of the week when you intend the premises
to be used for the activity.

TUESDAY

Start

End

Start

End

WEDNESDAY

Start

End

Start

End

THURSDAY

Start

End

Start

End

FRIDAY

Start

End

Start

End

SATURDAY

Start

End

Start

End

SUNDAY

Start

End

Start

End

Will the playing of recorded music take place indoors or outdoors or both?

Indoors

Outdoors

Both

Where taking place in a building or other structure tick as appropriate. Indoors may include a tent.

Continued from previous page...

State type of activity to be authorised, if not already stated, and give relevant further details, for example (but not exclusively) whether or not music will be amplified or unamplified.

MUSIC TO BE VIA TELEVISION AND AMPLIFIED WITH SPEAKERS TO COVER THE LICENSED AREAS

State any seasonal variations for playing recorded music

For example (but not exclusively) where the activity will occur on additional days during the summer months.

Non-standard timings. Where the premises will be used for the playing of recorded music at different times from those listed in the column on the left, list below

For example (but not exclusively), where you wish the activity to go on longer on a particular day e.g. Christmas Eve.

NEW YEARS EVE 08:00 TILL 02:00 THE FOLLOWING MORNING

Section 12 of 21

PROVISION OF PERFORMANCES OF DANCE

See guidance on regulated entertainment

Will you be providing performances of dance?

Yes

No

Section 13 of 21

PROVISION OF ANYTHING OF A SIMILAR DESCRIPTION TO LIVE MUSIC, RECORDED MUSIC OR PERFORMANCES OF DANCE

See guidance on regulated entertainment

Will you be providing anything similar to live music, recorded music or performances of dance?

Yes

No

Section 14 of 21

LATE NIGHT REFRESHMENT

Will you be providing late night refreshment?

Yes

No

Standard Days And Timings

MONDAY

Start

End

Start

End

Give timings in 24 hour clock.
(e.g., 16:00) and only give details for the days
of the week when you intend the premises
to be used for the activity.

Continued from previous page...

TUESDAY

Start 23:00

End 05:00

Start

End

WEDNESDAY

Start 23:00

End 05:00

Start

End

THURSDAY

Start 23:00

End 05:00

Start

End

FRIDAY

Start 23:00

End 05:00

Start

End

SATURDAY

Start 23:00

End 05:00

Start

End

SUNDAY

Start 23:00

End 05:00

Start

End

Will the provision of late night refreshment take place indoors or outdoors or both?

Indoors Outdoors Both

Where taking place in a building or other structure tick as appropriate. Indoors may include a tent.

State type of activity to be authorised, if not already stated, and give relevant further details, for example (but not exclusively) whether or not music will be amplified or unamplified.

State any seasonal variations

For example (but not exclusively) where the activity will occur on additional days during the summer months.

Continued from previous page...

Non-standard timings. Where the premises will be used for the supply of late night refreshments at different times from those listed in the column on the left, list below

For example (but not exclusively), where you wish the activity to go on longer on a particular day e.g. Christmas Eve.

Section 15 of 21

SUPPLY OF ALCOHOL

Will you be selling or supplying alcohol?

Yes No

Standard Days And Timings

MONDAY

Start

End

Start

End

Give timings in 24 hour clock.
(e.g., 16:00) and only give details for the days
of the week when you intend the premises
to be used for the activity.

TUESDAY

Start

End

Start

End

WEDNESDAY

Start

End

Start

End

THURSDAY

Start

End

Start

End

FRIDAY

Start

End

Start

End

SATURDAY

Start

End

Start

End

SUNDAY

Start

End

Start

End

Continued from previous page...

Will the sale of alcohol be for consumption:

- On the premises Off the premises Both

If the sale of alcohol is for consumption on the premises select on, if the sale of alcohol is for consumption away from the premises select off. If the sale of alcohol is for consumption on the premises and away from the premises select both.

State any seasonal variations

For example (but not exclusively) where the activity will occur on additional days during the summer months.

Non-standard timings. Where the premises will be used for the supply of alcohol at different times from those listed in the column on the left, list below

For example (but not exclusively), where you wish the activity to go on longer on a particular day e.g. Christmas Eve.

State the name and details of the individual whom you wish to specify on the licence as premises supervisor

Name

First name

Family name

Date of birth / /
dd mm yyyy

Enter the contact's address

Building number or name

Street

District

City or town

County or administrative area

Postcode

Country

Personal Licence number (if known)

Continued from previous page...

Issuing licensing authority
(if known)

BLACKPOOL

PROPOSED DESIGNATED PREMISES SUPERVISOR CONSENT

How will the consent form of the proposed designated premises supervisor be supplied to the authority?

- Electronically, by the proposed designated premises supervisor
- As an attachment to this application

Reference number for consent form (if known)

If the consent form is already submitted, ask the proposed designated premises supervisor for its 'system reference' or 'your reference'.

Section 16 of 21

ADULT ENTERTAINMENT

Highlight any adult entertainment or services, activities, or other entertainment or matters ancillary to the use of the premises that may give rise to concern in respect of children

Give information about anything intended to occur at the premises or ancillary to the use of the premises which may give rise to concern in respect of children, regardless of whether you intend children to have access to the premises, for example (but not exclusively) nudity or semi-nudity, films for restricted age groups etc gambling machines etc.

Section 17 of 21

HOURS PREMISES ARE OPEN TO THE PUBLIC

Standard Days And Timings

MONDAY

Start

End

Start

End

Give timings in 24 hour clock. (e.g., 16:00) and only give details for the days of the week when you intend the premises to be used for the activity.

TUESDAY

Start

End

Start

End

WEDNESDAY

Start

End

Start

End

THURSDAY

Start

End

Start

End

Continued from previous page...

FRIDAY

Start End

Start End

SATURDAY

Start End

Start End

SUNDAY

Start End

Start End

State any seasonal variations

For example (but not exclusively) where the activity will occur on additional days during the summer months.

Non standard timings. Where you intend to use the premises to be open to the members and guests at different times from those listed in the column on the left, list below

For example (but not exclusively), where you wish the activity to go on longer on a particular day e.g. Christmas Eve.

24 AND 31 DECEMBER EVERY YEAR TILL FROM 11:00 TILL 02:00 ON THE FOLLOWING DAY

Section 18 of 21

LICENSING OBJECTIVES

Describe the steps you intend to take to promote the four licensing objectives:

a) General – all four licensing objectives (b,c,d,e)

List here steps you will take to promote all four licensing objectives together.

The prevention of crime and disorder: for example drug-related problems, disorder, drunkenness and anti-social behaviour
public safety: the physical safety of people using the venue
the prevention of public nuisance: for example noise from music, litter and light pollution
the protection of children from harm: including moral, psychological and physical harm.
The public safety objective is concerned with the physical safety of the people performing in and staff and customers using the relevant premises and not with public health.

b) The prevention of crime and disorder

A C.C.T.V. system has been installed and is working to the satisfaction of Thames Valley Police and the Licensing Authority.

Recordings will be maintained for an appropriate period of time to be agreed with the Police and the Licensing Authority.

Continued from previous page...

I intend to promote
the 4 licensing
objectives by

If the C.C.T.V. equipment fails, then Police and the Licensing Authority will be informed immediately by telephone and immediate steps will be taken to put the equipment back into working order.

A notice will be displayed at the entrance to the premises advising that C.C.T.V. is in operation.

At least one C.C.T.V. camera will be in operation at the front of the premises at all times when the premises is in use.

Bottles and glasses

Alcohol and soft drinks will be served in plastic or toughened glasses.

All bottles sold will be made of plastic (where available).

Where glass bottles are to be used the contents will be decanted into plastic or toughened glasses where it is not intended that the contents are to be consumed direct from the bottle.

Customers carrying open or sealed bottles or glasses will not be admitted to the premises at any time.

Customers will not be permitted to take open containers of alcohol or soft drinks from the premises.

All bottles and glasses are to be removed from public areas as soon as the contents have been drunk or are empty.

Bottle bins for collection or empty bottles will not be accessible to members of the public

We have a proof of age policy that has been formulated in discussion with the Police and the Licensing Authority.

Drinks Promotions

All-inclusive nights or other irresponsible drinks promotions will not be permitted.

The Designated Premises Supervisor or a Personal Licence holder will be in charge of the premises when any drinks promotions are taking place.

We have an anti-drugs policy that has been agreed following discussion with the Police and the Licensing Authority and is in line with the Safer Clubbing Guidance.

A secure facility to store controlled drugs prior to collection is available.

A drugs register will be maintained.

The Police will be notified of all seizures of controlled drugs.

Crime prevention notices are displayed warning customers of the possibility of crime which may target them, e.g. "Bags should not be left unattended", "Watch out for Pickpockets".

A detailed "Customer Code of Conduct" poster is conspicuously displayed warning customers that if they act in an inappropriate manner they could be barred from all licensed premises in the vicinity.

Any restrictions on the admission of children to the premises are conspicuously displayed outside the premises

A Personal Licence holder will be at the premises at all times when alcohol is being sold or regulated entertainment is being

Continued from previous page...

provided.

We have a policy on the safe management of large groups, i.e. hen and stag parties.

A secure area for customer's personal belongings is available.

We provide food that is available at all times when the premises are open

c) Public safety

We have conducted a suitable Fire Risk Assessment at the premises and implemented the necessary control measures.

All exit doors are easily operable without the use of a key, card, code or similar means.

Exit doors are regularly checked to ensure they function satisfactorily.

Records of all these checks are kept and can be produced on request.

All removable security fastenings are removed whenever the premises are open to the public or staff.

All fire doors are maintained unobstructed and effectively selfclosing and will not be held open other than with approved devices.

Fire resistant doors to service shafts, ducts and cupboards are kept locked shut.

Step and stair edges are appropriately highlighted so as to be conspicuous.

Hangings, curtains and temporary decorations are maintained in a flame retardant condition.

Upholstered seating is fire retardant and complies with current fire safety regulations.

Curtains, hangings and temporary decorations are located so as not to obstruct exits, fire safety signs or fire-fighting equipment.

Notices detailing the actions to be taken in the event of fire or other emergency are prominently displayed and maintained in good condition.

Access is provided for emergency vehicles and kept clear and free from obstruction at all times

. The premises have current certificates of inspection for all portable fire fighting equipment. An inspection is carried out every 6 Months and new certificates will be obtained at these intervals.

The premises have a current certificate of inspection for the fire detection alarm. An inspection is carried out every 6 months year(s) and a new certificate will be obtained at these intervals.

Any temporary electrical installation being used is checked before use by a N.I.C.E.I.C. or E.C.A. electrician and a temporary electrical installation report or a certificate of compliance with Britis

d) The prevention of public nuisance

A noise management plan has been devised and is in operation at the premises.

Noise or vibration from the premises will be maintained at a level that will not be audible at the façade of any

Continued from previous page...

neighbouring noise sensitive premises.

Doors and windows will be kept closed when regulated entertainment is taking place.

All windows are double glazed to minimise the breakout of noise.

All entrances and exits have an effective lobby to minimise the breakout of noise.

Noise limiters can be fitted to amplification equipment and have been set at a level agreed with the local authority.

Prominent, clear and legible notices are displayed at all exits requesting patrons to respect the needs of local residents and to leave the premises and the area quietly.

The use of explosives, pyrotechnics and fireworks of a similar nature which could cause disturbance in surrounding areas is not permitted.

Disposal of empty bottles into waste receptacles outside the premises will not be permitted to take place between the hours of 23:00 hrs and 07:00 hrs to minimise disturbance to nearby occupiers.

For the final hours of opening the music is reduced in volume and is discernibly quieter.

The playing of live or recorded music in garden or outside seating areas of the premises is not permitted after 20:00 hrs.

The garden or outside seating areas are closed to the public after 22:00hrs.

All fixed plant and equipment at the premises e.g. ventilation systems that produce significant levels of noise are fitted with appropriate means of noise suppression and are restricted in their use so as to minimise disturbance to any neighbouring noise sensitive premises.

A full acoustic survey into the impact of noise from the premises will be carried out by a competent person. All recommendations have been carried out.

Children's inflatable play equipment will not be in use at the premises.

Noxious smells

All ventilation and extract systems are designed and maintained so as to prevent noxious smells causing a nuisance to nearby properties.

Refuse receptacles are cleaned with disinfectant at least weekly.

Light pollution

Flashing / bright / flood lights used outside the premises and any security or access lighting installed will not be operated so as to cause a nuisance to nearby occupiers.

All external lighting, including floodlighting, is directed away from adjacent occupiers.

Litter

146. 2 litter receptacles are placed outside the premises for customers to use and are emptied at least daily. The premises has a waste collection contract with Blackpool Council who remove waste.

Staff undertake a litter pick to a distance of 2 metres around the premises daily

Continued from previous page...

e) The protection of children from harm

The premises operates a proof of age policy that has been agreed by the police. Challenge 25

When children are allowed on the premises, a "no smoking" area of such a size and design that it genuinely provides a suitable, comfortable area for children and families wishing to be separated from smoking areas will be available on the outside seating area
A crime prevention policy agreed by the police and local authority is in place

Section 19 of 21

NOTES ON DEMONSTRATING ENTITLEMENT TO WORK IN THE UK

Continued from previous page...

Entitlement to work/immigration status for individual applicants and applications from partnerships which are not limited liability partnerships:

A licence may not be held by an individual or an individual in a partnership who is resident in the UK who:

- does not have the right to live and work in the UK; or
- is subject to a condition preventing him or her from doing work relating to the carrying on of a licensable activity.

Any premises licence issued in respect of an application made on or after 6 April 2017 will become invalid if the holder ceases to be entitled to work in the UK.

Applicants must demonstrate that they have an entitlement to work in the UK and are not subject to a condition preventing them from doing work relating to the carrying on of a licensable activity. They do this in one of two ways: 1) by providing with this application copies or scanned copies of the documents listed below (which do not need to be certified), or 2) by providing their 'share code' to enable the licensing authority to carry out a check using the Home Office online right to work checking service (see below).

Documents which demonstrate entitlement to work in the UK

- An expired or current passport showing the holder, or a person named in the passport as the child of the holder, is a British citizen or a citizen of the UK and Colonies having the right of abode in the UK [please see note below about which sections of the passport to copy].
- An expired or current passport or national identity card showing the holder, or a person named in the passport as the child of the holder, is a national of a European Economic Area country or Switzerland.
- A Registration Certificate or document certifying permanent residence issued by the Home Office to a national of a European Economic Area country or Switzerland.
- A Permanent Residence Card issued by the Home Office to the family member of a national of a European Economic Area country or Switzerland.
- A **current** Biometric Immigration Document (Biometric Residence Permit) issued by the Home Office to the holder indicating that the person named is allowed to stay indefinitely in the UK, or has no time limit on their stay in the UK.
- A **current** passport endorsed to show that the holder is exempt from immigration control, is allowed to stay indefinitely in the UK, has the right of abode in the UK, or has no time limit on their stay in the UK.
- A **current** Immigration Status Document issued by the Home Office to the holder with an endorsement indicating that the named person is allowed to stay indefinitely in the UK or has no time limit on their stay in the UK, **when produced in combination with** an official document giving the person's permanent National Insurance number and their name issued by a Government agency or a previous employer.
- A birth or adoption certificate issued in the UK, **when produced in combination with** an official document giving the person's permanent National Insurance number and their name issued by a Government agency or a previous employer.
- A birth or adoption certificate issued in the Channel Islands, the Isle of Man or Ireland **when produced in combination with** an official document giving the person's permanent National Insurance number and their name issued by a Government agency or a previous employer.
- A certificate of registration or naturalisation as a British citizen, **when produced in combination with** an official document giving the person's permanent National Insurance number and their name issued by a Government agency or a previous employer.

Continued from previous page...

- A **current** passport endorsed to show that the holder is allowed to stay in the UK and is currently allowed to work and is not subject to a condition preventing the holder from doing work relating to the carrying on of a licensable activity.
- A **current** Biometric Immigration Document (Biometric Residence Permit) issued by the Home Office to the holder which indicates that the named person can currently stay in the UK and is allowed to work relation to the carrying on of a licensable activity.
- A **current** Residence Card issued by the Home Office to a person who is not a national of a European Economic Area state or Switzerland but who is a family member of such a national or who has derivative rights or residence.
- A **current** Immigration Status Document containing a photograph issued by the Home Office to the holder with an endorsement indicating that the named person may stay in the UK, and is allowed to work and is not subject to a condition preventing the holder from doing work relating to the carrying on of a licensable activity **when produced in combination with** an official document giving the person's permanent National Insurance number and their name issued by a Government agency or a previous employer.
- A Certificate of Application, **less than 6 months old**, issued by the Home Office under regulation 18(3) or 20(2) of the Immigration (European Economic Area) Regulations 2016, to a person who is not a national of a European Economic Area state or Switzerland but who is a family member of such a national or who has derivative rights of residence.
- Reasonable evidence that the person has an outstanding application to vary their permission to be in the UK with the Home Office such as the Home Office acknowledgement letter or proof of postage evidence, or reasonable evidence that the person has an appeal or administrative review pending on an immigration decision, such as an appeal or administrative review reference number.
- Reasonable evidence that a person who is not a national of a European Economic Area state or Switzerland but who is a family member of such a national or who has derivative rights of residence in exercising treaty rights in the UK including:-
 - evidence of the applicant's own identity – such as a passport,
 - evidence of their relationship with the European Economic Area family member – e.g. a marriage certificate, civil partnership certificate or birth certificate, and
 - evidence that the European Economic Area national has a right of permanent residence in the UK or is one of the following if they have been in the UK for more than 3 months:
 - (i) working e.g. employment contract, wage slips, letter from the employer,
 - (ii) self-employed e.g. contracts, invoices, or audited accounts with a bank,
 - (iii) studying e.g. letter from the school, college or university and evidence of sufficient funds; or
 - (iv) self-sufficient e.g. bank statements.

Family members of European Economic Area nationals who are studying or financially independent must also provide evidence that the European Economic Area national and any family members hold comprehensive sickness insurance in the UK. This can include a private medical insurance policy, an EHIC card or an S1, S2 or S3 form.

Original documents must not be sent to licensing authorities. If the document copied is a passport, a copy of the following pages should be provided:-

- (i) any page containing the holder's personal details including nationality;
- (ii) any page containing the holder's photograph;
- (iii) any page containing the holder's signature;
- (iv) any page containing the date of expiry; and
- (v) any page containing information indicating the holder has permission to enter or remain in the UK and is permitted to work.

Continued from previous page...

If the document is not a passport, a copy of the whole document should be provided.

Your right to work will be checked as part of your licensing application and this could involve us checking your immigration status with the Home Office. We may otherwise share information with the Home Office. Your licence application will not be determined until you have complied with this guidance.

Home Office online right to work checking service

As an alternative to providing a copy of the documents listed above, applicants may demonstrate their right to work by allowing the licensing authority to carry out a check with the Home Office online right to work checking service.

To demonstrate their right to work via the Home Office online right to work checking service, applicants should include in this application their 9-digit share code (provided to them upon accessing the service at <https://www.gov.uk/prove-right-to-work>) which, along with the applicant's date of birth (provided within this application), will allow the licensing authority to carry out the check.

In order to establish the applicant's right to work, the check will need to indicate that the applicant is allowed to work in the United Kingdom and is not subject to a condition preventing them from doing work relating to the carrying on of a licensable activity.

An online check will not be possible in all circumstances because not all applicants will have an immigration status that can be checked online. The Home Office online right to work checking service sets out what information and/or documentation applicants will need in order to access the service. Applicants who are unable to obtain a share code from the service should submit copy documents as set out above.

Section 20 of 21

NOTES ON REGULATED ENTERTAINMENT

Continued from previous page...

In terms of specific **regulated entertainments** please note that:

- Plays: no licence is required for performances between 08:00 and 23.00 on any day, provided that the audience does not exceed 500.
- Films: no licence is required for 'not-for-profit' film exhibition held in community premises between 08.00 and 23.00 on any day provided that the audience does not exceed 500 and the organiser (a) gets consent to the screening from a person who is responsible for the premises; and (b) ensures that each such screening abides by age classification ratings.
- Indoor sporting events: no licence is required for performances between 08.00 and 23.00 on any day, provided that the audience does not exceed 1000.
- Boxing or Wrestling Entertainment: no licence is required for a contest, exhibition or display of Greco-Roman wrestling, or freestyle wrestling between 08.00 and 23.00 on any day, provided that the audience does not exceed 1000. Combined fighting sports – defined as a contest, exhibition or display which combines boxing or wrestling with one or more martial arts – are licensable as a boxing or wrestling entertainment rather than an indoor sporting event.
- Live music: no licence permission is required for:
 - o a performance of unamplified live music between 08.00 and 23.00 on any day, on any premises.
 - o a performance of amplified live music between 08.00 and 23.00 on any day on premises authorised to sell alcohol for consumption on those premises, provided that the audience does not exceed 500.
 - o a performance of amplified live music between 08.00 and 23.00 on any day, in a workplace that is not licensed to sell alcohol on those premises, provided that the audience does not exceed 500.
 - o a performance of amplified live music between 08.00 and 23.00 on any day, in a church hall, village hall, community hall, or other similar community premises, that is not licensed by a premises licence to sell alcohol, provided that (a) the audience does not exceed 500, and (b) the organiser gets consent for the performance from a person who is responsible for the premises.
 - o a performance of amplified live music between 08.00 and 23.00 on any day, at the non-residential premises of (i) a local authority, or (ii) a school, or (iii) a hospital, provided that (a) the audience does not exceed 500, and (b) the organiser gets consent for the performance on the relevant premises from: (i) the local authority concerned, or (ii) the school or (iii) the health care provider for the hospital.
- Recorded Music: no licence permission is required for:
 - o any playing of recorded music between 08.00 and 23.00 on any day on premises authorised to sell alcohol for consumption on those premises, provided that the audience does not exceed 500.
 - o any playing of recorded music between 08.00 and 23.00 on any day, in a church hall, village hall, community hall, or other similar community premises, that is not licensed by a premises licence to sell alcohol, provided that (a) the audience does not exceed 500, and (b) the organiser gets consent for the performance from a person who is responsible for the premises.
 - o any playing of recorded music between 08.00 and 23.00 on any day, at the non-residential premises of (i) a local authority, or (ii) a school, or (iii) a hospital, provided that (a) the audience does not exceed 500, and (b) the organiser gets consent for the performance on the relevant premises from: (i) the local authority concerned, or (ii) the school proprietor or (iii) the health care provider for the hospital.

Continued from previous page...

- Dance: no licence is required for performances between 08.00 and 23.00 on any day, provided that the audience does not exceed 500. However, a performance which amounts to adult entertainment remains licensable.
- Cross activity exemptions: no licence is required between 08.00 and 23.00 on any day, with no limit on audience size for:
 - o any entertainment taking place on the premises of the local authority where the entertainment is provided by or on behalf of the local authority;
 - o any entertainment taking place on the hospital premises of the health care provider where the entertainment is provided by or on behalf of the health care provider;
 - o any entertainment taking place on the premises of the school where the entertainment is provided by or on behalf of the school proprietor; and
 - o any entertainment (excluding films and a boxing or wrestling entertainment) taking place at a travelling circus, provided that (a) it takes place within a moveable structure that accommodates the audience, and (b) that the travelling circus has not been located on the same site for more than 28 consecutive days.

Section 21 of 21

PAYMENT DETAILS

This fee must be paid to the authority. If you complete the application online, you must pay it by debit or credit card.

Premises Licence Fees are determined by the non-domestic rateable value of the premises.

To find out a premises non domestic rateable value go to the Valuation Office Agency site at http://www.voa.gov.uk/business_rates/index.htm

Band A - No RV to £4300 £100.00

Band B - £4301 to £33000 £190.00

Band C - £33001 to £87000 £315.00

Band D - £87001 to £125000 £450.00*

Band E - £125001 and over £635.00*

*If the premises rateable value is in Bands D or E and the premises is primarily used for the consumption of alcohol on the premises then you are required to pay a higher fee

Band D - £87001 to £12500 £900.00

Band E - £125001 and over £1,905.00

There is an exemption from the payment of fees in relation to the provision of regulated entertainment at church halls, chapel halls or premises of a similar nature, village halls, parish or community halls, or other premises of a similar nature. The costs associated with these licences will be met by central Government. If, however, the licence also authorises the use of the premises for the supply of alcohol or the provision of late night refreshment, a fee will be required.

Schools and sixth form colleges are exempt from the fees associated with the authorisation of regulated entertainment where the entertainment is provided by and at the school or college and for the purposes of the school or college.

If you operate a large event you are subject to ADDITIONAL fees based upon the number in attendance at any one time

Capacity 5000-9999 £1,000.00

Capacity 10000 -14999 £2,000.00

Capacity 15000-19999 £4,000.00

Capacity 20000-29999 £8,000.00

Capacity 30000-39000 £16,000.00

Capacity 40000-49999 £24,000.00

Capacity 50000-59999 £32,000.00

Capacity 60000-69999 £40,000.00

Capacity 70000-79999 £48,000.00

Capacity 80000-89999 £56,000.00

Capacity 90000 and over £64,000.00

* Fee amount (£)

190.00

ATTACHMENTS

AUTHORITY POSTAL ADDRESS

Continued from previous page...

Address

Building number or name	<input type="text"/>
Street	<input type="text"/>
District	<input type="text"/>
City or town	<input type="text"/>
County or administrative area	<input type="text"/>
Postcode	<input type="text"/>
Country	<input type="text" value="United Kingdom"/>

DECLARATION

[Applicable to individual applicants only, including those in a partnership which is not a limited liability partnership] I understand I am not entitled to be issued with a licence if I do not have the entitlement to live and work in the UK (or if I am subject to a condition preventing me from doing work relating to the carrying on of a licensable activity) and that my licence will become invalid if I cease to be entitled to live and work in the UK (please read guidance note 15).

The DPS named in this application form is entitled to work in the UK (and is not subject to conditions preventing him or her from doing work relating to a licensable activity) and I have seen a copy of his or her proof of entitlement to work, if appropriate (please see note 15)

Ticking this box indicates you have read and understood the above declaration

This section should be completed by the applicant, unless you answered "Yes" to the question "Are you an agent acting on behalf of the applicant?"

* Full name	<input type="text"/>
* Capacity	<input type="text"/>
Date (dd/mm/yyyy)	<input type="text"/>

Once you're finished you need to do the following:

1. Save this form to your computer by clicking file/save as...
2. Go back to <https://www.gov.uk/apply-for-a-licence/premises-licence/blackpool/apply-1> to upload this file and continue with your application.

Don't forget to make sure you have all your supporting documentation to hand.

IT IS AN OFFENCE LIABLE TO SUMMARY CONVICTION TO A FINE OF ANY AMOUNT UNDER SECTION 158 OF THE LICENSING ACT 2003, TO MAKE A FALSE STATEMENT IN OR IN CONNECTION WITH THIS APPLICATION

IT IS AN OFFENCE UNDER SECTION 24B OF THE IMMIGRATION ACT 1971 FOR A PERSON TO WORK WHEN THEY KNOW, OR HAVE REASONABLE CAUSE TO BELIEVE, THAT THEY ARE DISQUALIFIED FROM DOING SO BY REASON OF THEIR IMMIGRATION STATUS. THOSE WHO EMPLOY AN ADULT WITHOUT LEAVE OR WHO IS SUBJECT TO CONDITIONS AS TO EMPLOYMENT WILL BE LIABLE TO A CIVIL PENALTY UNDER SECTION 15 OF THE IMMIGRATION, ASYLUM AND NATIONALITY ACT 2006 AND PURSUANT TO SECTION 21 OF THE SAME ACT, WILL BE COMMITTING AN OFFENCE WHERE THEY DO SO IN THE KNOWLEDGE, OR WITH REASONABLE CAUSE TO BELIEVE, THAT THE EMPLOYEE IS DISQUALIFIED

Blackpool Council

CONSENT OF DPS FORM

Premises Licence holder(s):	JOSE SACHEZ. CUBE HOTELS BLACKPOOL LTD
------------------------------------	-------------------------------------------



Licensing Service
Blackpool Council
Municipal Buildings, PO Box 4
Blackpool, FY1 1NA

Contact
T: (01253) 47 8572 / 8589
F: (01253) 47 8372
www.blackpool.gov.uk/licensing

LS/F/005/2/4

Schedule 11

Consent of an individual to being specified as a premises supervisor

Full name of the prospective premises supervisor:	Type of Application <small>(Delete as appropriate)</small>
JOSE MIGUEL SANCHEZ	New Premises Licence Variation of DPS

Home address of the prospective premises supervisor:

Full name(s) of Premises Licence holder:	Premises Licence number (if any):
CUBE HOTELS BLACKPOOL LTD	NEW APPLICATION

Name and address of the premises to which the application relates:
BARROWS HOTEL (CUBE HOTELS BLACKPOOL LTD) 58/60 HURMBY ROAD Blackpool FY1 4QJ

I, the prospective Designated Premises Supervisor named above, hereby confirm that I give my consent to be specified as the DPS in relation to the above premises licence and any premises licence to be granted or varied in respect of this application made by the above mentioned applicant concerning the supply of alcohol at the premises.
 I also confirm that I am entitled to work in the United Kingdom and am applying for, intend to apply for or currently hold a personal licence, details as set out below.

Personal Licence Number:	PA 5651
Name of Personal Licence issuing authority:	BLACKPOOL
Address of Issuing authority:	Blackpool Council Corporation Street, Blackpool FY1 1NF
Telephone of issuing authority:	01253 658583
Signed by proposed DPS:	
Print Name:	Jose Miguel Sanchez
Date:	16/01/2024

Revision

AO22/03 1/JO 1

DRAWING No.

DO NOT SCALE DIMENSIONS FROM DRAWING

LAYOUT TO BE APPROVED BY BUILDING CONTROL # LOCAL FIRE OFFICER.

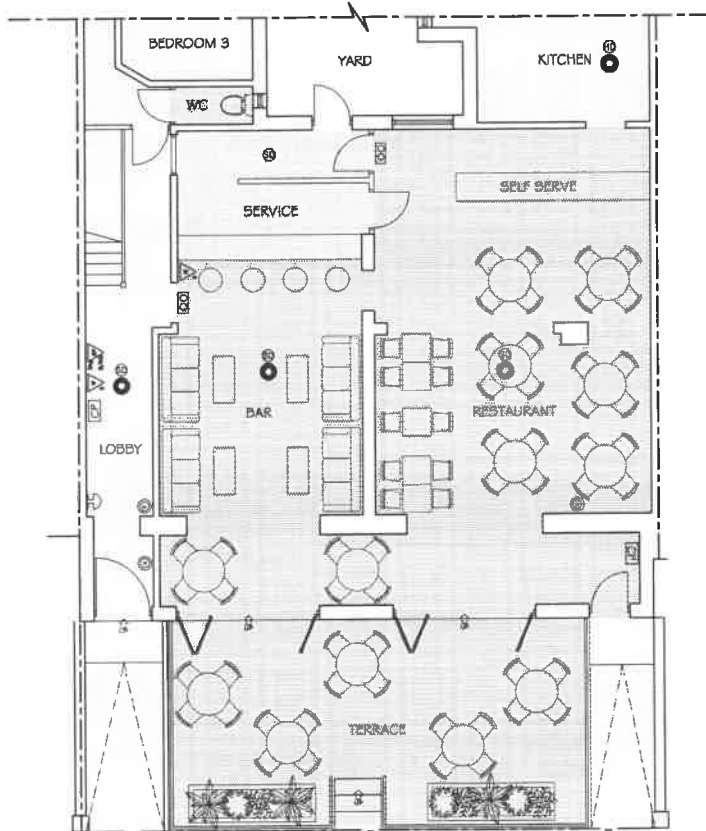

DRAWING KEY

- DRY AREA
- BEER / BOTTLE STORE
- BAR / SERVICE / WET AREA
- W/C
- DENOTES: BS5809 INTER LINKED MAINS OPERATED SMOKE ALARM WITH BATTERY BACK UP
- INTERLINKED MAINS OPERATED HEAT DETECTOR
- DENOTES FIRE ESCAPE LIGHTING
- EMERGENCY LIGHT
- ALARM SIREN
- ALARM BREAK POINT
- EXTINGUISHER
- CONTROL PANEL

PARTIAL GROUND FLOOR PLAN

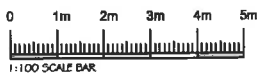

Keystone Design Associates Ltd.

Registered Office
Development House
261 Church Street
Blackpool
FY1 3PB
Tel. No. 01253 648040
Fax. No. 01253 752801
Email : Info@keystonedesign.co.uk

PROJECT ADDRESS		58-60 HORNBY ROAD BLACKPOOL, LANCASHIRE	
CLIENT	MR SANCHEZ	DRAWING TITLE	LICENSING PLAN
DRAWN	LM	SCALE	1:100@A3
		DATE	16-03-22
DRAWING No.	AO22/03 1/JO 1		REVISION

Find and update company information

~~Companies House does not verify the accuracy of the information filed~~
(<http://resources.companieshouse.gov.uk/serviceInformation.shtml#complInfo>)
[Advanced company search \(/advanced-search\)](#)

CUBE HOTELS BLACKPOOL LTD

Company number **13922729**

[Follow this company](#)

File for this company
(https://beta.companieshouse.gov.uk/company/13922729/authorise?return_to=/company/13922729)

Overview

[Filing history](#)

[People](#)

[More](#)

Registered office address

56 Hornby Road, Blackpool, England, FY1 4QJ

Company status

Active

Company type

Private limited Company

Incorporated on

17 February 2022

Accounts

Next accounts made up to **28 February 2024**
due by **30 November 2024**

Last accounts made up to **28 February 2023**

Confirmation statement

Next statement date **25 July 2024**
due by **8 August 2024**

Last statement dated **25 July 2023**

Nature of business (SIC)

- 55100 - Hotels and similar accommodation

[Tell us what you think of this service \(https://www.smartsurvey.co.uk/s/getcompanyinformation/\)](https://www.smartsurvey.co.uk/s/getcompanyinformation/) [Is there anything wrong with this page? \(/help/feedback?sourceurl=https://find-and-update.company-information.service.gov.uk/company/13922729\)](https://find-and-update.company-information.service.gov.uk/company/13922729)

[Policies Link opens in new tab](#)

[Cookies \(https://beta.companieshouse.gov.uk/help/cookies\)](https://beta.companieshouse.gov.uk/help/cookies)

[Contact us Link opens in new tab](#)

[Accessibility statement](#)

[\(/https://beta.companieshouse.gov.uk/help/accessibility-statement\)](https://beta.companieshouse.gov.uk/help/accessibility-statement)

[Developers Link opens in new tab](#)

Built by [Companies House](#)

© Crown copyright

Blackpool Council Licensing Service			
Notification of Mediation Agreement			
Premises Details			
Name of Premises:	Barrons Hotel		
Premises Address:	58-60 Hornby Road, Blackpool		
Post Code:	FY1 4QJ		
Responsible Authority			
Service / Department	Lancashire Constabulary		
Officer (Print Name)	PC 515 Guy HARRISON		
	Signature		
Proposed changes to Application Operational Schedule			Mark one
Adequate changes proposed during the representation period. No representation made.			X
Some changes proposed. Representation will follow for remaining concerns.			
Some changes made after representation submitted. Continue to hearing.			
Full and adequate proposals made after representation. Representation withdrawn.			
Applicant's consent to amend Licence Application			
I the undersigned am the applicant and hereby authorize Blackpool Licensing Service to amend my application as detailed below. I understand that these amendments may be included as conditions on the Premises Licence should one be issued.			
Applicant's Name (Please <u>print</u> clearly)	Jose Miguel Sanchez		
Applicant's Usual Signature			
Date of signing			2024
Amendments			
1	<p>The following conditions to be added to the Operating Schedule:-</p> <p>1. The licence holder and the DPS are to support and rigorously enforce a Challenge 25 Proof of Age policy. Any person who looks or appears to be under the age of 25 shall be asked to provide identification that they are over the age of 18. The following are the only forms of identification acceptable:</p> <p>(i) UK photo driving licence (ii) passport (iii) Proof of Age Standards Scheme Card</p> <p>OR any other nationally or locally approved form of identification which may be introduced in the future.</p> <p>If no suitable identification is provided, sale of alcohol to them will be refused.</p>		

Signs promoting this policy shall be displayed in the premises.

2. All staff to have received suitable training in relation to the proof of age scheme to be applied upon the premises. Records to evidence this will be made available to an authorised officer upon request.
3. An authorisation of sales, signed and dated by the DPS, shall be kept at the premises showing all persons authorised by them to make sales of alcohol at the premises.
4. Security/staff arrangements will be sufficient to discourage the sale and consumption of drugs and shall ensure such arrangements include regular documented checks of toilets.
5. An adequate number of licensed door supervisors shall be on duty as appropriate to any risk assessment determined by the premises licence holder.
6. All non- residents must leave the premises by 23:00 hours.
7. Any outside area which is used for the consumption of alcohol shall cease to be so used at 22:00hrs.
8. Any persons under 18 years of age must be accompanied by a responsible adult and remain the responsibility of the accompanying adult when using the premises. Staff are not allowed to be in sole supervision of children, who remain the responsibility of the accompanying adult at all times.
9. All children must leave the bar area by 23:00 hours.
10. CCTV will be installed internally at the premises and will comply with the following:
 - a) The CCTV system shall be installed, maintained and operated to the reasonable satisfaction of Lancashire Constabulary. The entrance and bar areas are to be covered by the system. The system will incorporate a camera covering each of the entrance doors and will be capable of providing an image which is regarded as identification standard.
 - b) The system will display on any recording the correct time and date of the recording.
 - c) Digital recording shall be held for a minimum of 28 days respectively, after the recording is made and will be made available to the Police or any authorised persons acting for Responsible Authority for inspection upon request.
11. All windows and doors will be closed at or before 23:00 hrs.
12. Residents and bona fide guests of Barrons Hotel and the Tamarind Hotel 56 Hornby Road, Blackpool, may be served alcohol for consumption on the premises 24 hours a day. For the avoidance of doubt, residents of 56 Hornby Road are not permitted to remove alcohol from 58-60 Hornby Road, even to take it back to their own hotel room.

2

The following conditions to be removed from the operating schedule:

1. The applicant does NOT now wish to apply for a late night refreshments licence.
2. The applicant does NOT now wish to apply for an off premises alcohol licence.

* To insert an additional row place the cursor in the last row and select '*Table*' – '*Insert*' – '*Rows below*' from the top menu bar

This page is intentionally left blank

From: [\(Cllr\) Mark Smith](#)
To: [Licensing la2003](#)
Cc: [\(Cllr\) Jane Hugo](#)
Subject: Re: Barrons Hotel, 58 - 60 Hornby Road
Date: 14 February 2024 11:18:39

Lisa

Regarding application for the Barrons Hotel, Hornby Road.

Representations and reviews must be relevant to one of the 4 licensing objectives:

- Prevention of crime and disorder
Since the original application was agreed I have received a large number of complaints regarding the Barrons Hotel, with police being called out nearly daily, and personally witnessed this myself, due to this I feel the business is unable to manage the premisses, and should not be given a license
- Public safety
The same reason as to Prevention of crime and disorder
- Prevention of public nuisance
The same reason as to Prevention of crime and disorder
- Protection of children from harm
Children should not be witnessing the constant visits from the police, so not suitable for a license

Many thanks,

Councillor Mark Smith
Councillor for Talbot Ward
Cabinet Member for Levelling Up (Place).

This page is intentionally left blank